

# 24" SQUARE SUCTION OUTLET COVER FOR NEW CONSTRUCTION FOR CONCRETE INSTALLATIONS



**VGBA CERTIFIED  
SPECIFICATIONS**

**Open Area**  
253 in<sup>2</sup>

For SOFA Specific Flow Ratings and  
specifications please scan QR code or visit  
[www.aquastarpoolproducts.com/flowcode](http://www.aquastarpoolproducts.com/flowcode)



## FEATURES

Certified, Listed, and Labeled in conformance with APSP/ANSI/ICC-16 2017 and NSF/ANSI/CAN 50 standards

Manufactured from superior  
UV-resistant PVC

#316 stainless steel screws

Trademarked VGBA compliance button easily identifies VGBA 2017 compliant cover from on deck and underwater

Online product support including downloadable CAD files, General Certificate of Conformity, third-party certificate, installation instructions and more

Replace drain cover every ten years from the date of installation

1 per case

**1824 UNIVERSAL**  
HIGH-FLOW COVER FOR 18" MUD FRAMES

**NEW Unblockable!**

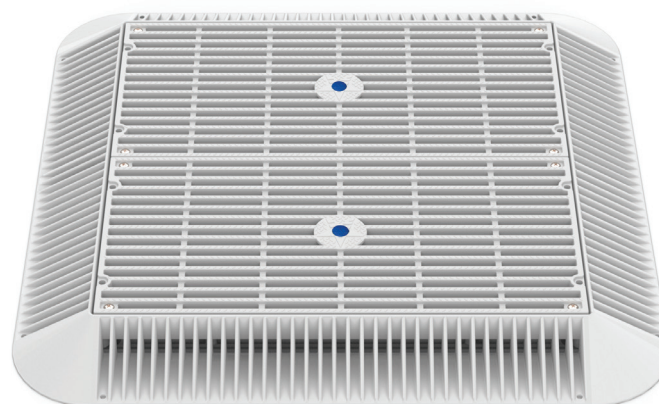

Part #  
1824xxx (Standard)

## STANDARD COLORS

- ☐ 1824101 – White
- ☐ 1824117 – Medium Gray

**VGBA 2017 Compliant**

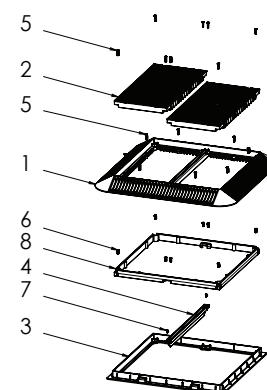
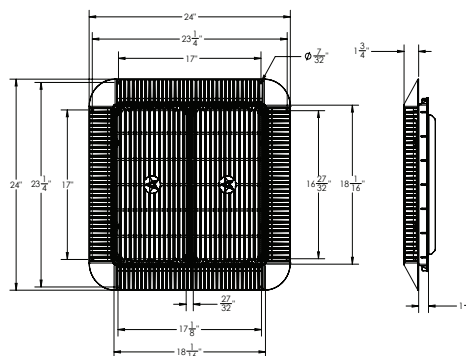

1. 18" x 24" Riser Ring
2. 9" x 18" Suction Outlet Cover, Qty 2
3. 18" x 24" Click-It Frame
4. 18" Support Bar
5. 10-32 x 3/4" Pan Head Phillips, 316 SS, Qty 16
6. 10-32 x 1/2" Pan Head Phillips, 316 SS, Qty 8
7. #8 x 1/2" Flat Head, Type A, 316 SS, Qty 2
8. Adapter Ring, 18" x 18" Drain System to 1824

P 877-768-2717 F 877-276-POOL Outside the US: P +1-949-336-1940 F +1-949-336-1940  
[info@aquastarpoolproducts.com](mailto:info@aquastarpoolproducts.com) [www.aquastarpoolproducts.com](http://www.aquastarpoolproducts.com) CS006-011724