

SWIVEL WHEEL FLEXIBLE VACUUMS - MODELS 250, 252

REPLACEMENT PARTS

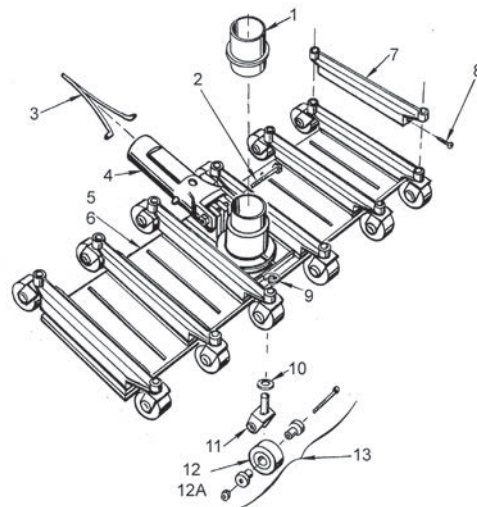

| Item | Part No. | Description |
|---------------|------------------------------|---|
| Product No. : | R201126 | R201136 |
| Model No. : | 250 | 252 |
| Description: | SWIVEL WHEEL FLEXIBLE VACUUM | |
| 1 | R201566 | Hose swivel adapter |
| 2 | R201496 | SS bolt and nut for handle |
| 3 | R22001 | Spring clip w/ High Performance Acetal Resin No. 170 |
| 4 | R201476 | Snap adapt handle w/ delrin clip No. 192 |
| 5 | R03012 | Flexible base 19 in. model No. 250 |
| 6 | R03013 | Flexible base 14 in. model No. 252 |
| 7 | R03032 | Caster support No. 265 ¹ |
| 8 | R01023 | Lead retainer screw ¹ |
| 9 | R03058 | SS retainer clip No. 267 ¹ |
| 10 | R201626 | Wheel adjustment washers No. 266 ¹ |
| 11 | R03026 | Swivel caster No. 263 ¹ |
| 12 | R03021 | Solid plastic wheel model No. 252 ¹ |
| 12A | R03022 | Solid polyurethane wheel model No. 250 ¹ |
| 13 | R201606 | Axle assembly (less wheel) No. 264 ¹ |
| 13 | R201500 | No. 250 Replacement kit, (4 each) No. 177 wheels, No. 263 casters, No. 264 axle assembly, No. 267 clips, bubble pack card |
| 13 | R201451 | No. 250 Replacement kit, (4 each) No. 174 wheels, No. 263 casters, No. 264 axle assembly, No. 267 clips, bubble pack card |



¹ Parts fit Model No. 215 Swivel wheel commercial vacuum.